



Progetto
Progetto
Ing. Luigi Severini

Oggetto
RILIEVO TOPOGRAFICO PLANOMETRICO:
AREA 1 - TRONCO A

Scala
1: 5000-500

Il Responsabile del Servizio LL.PP.: Arch. Lorenzo Natta

RIL03

Data di Revisione 2007

LEGENDA

- allacciamento alla rete idrica
- palo Enel
- pozzetto rete di fognatura nera

STRALCIO PLANIMETRICO 1: 500

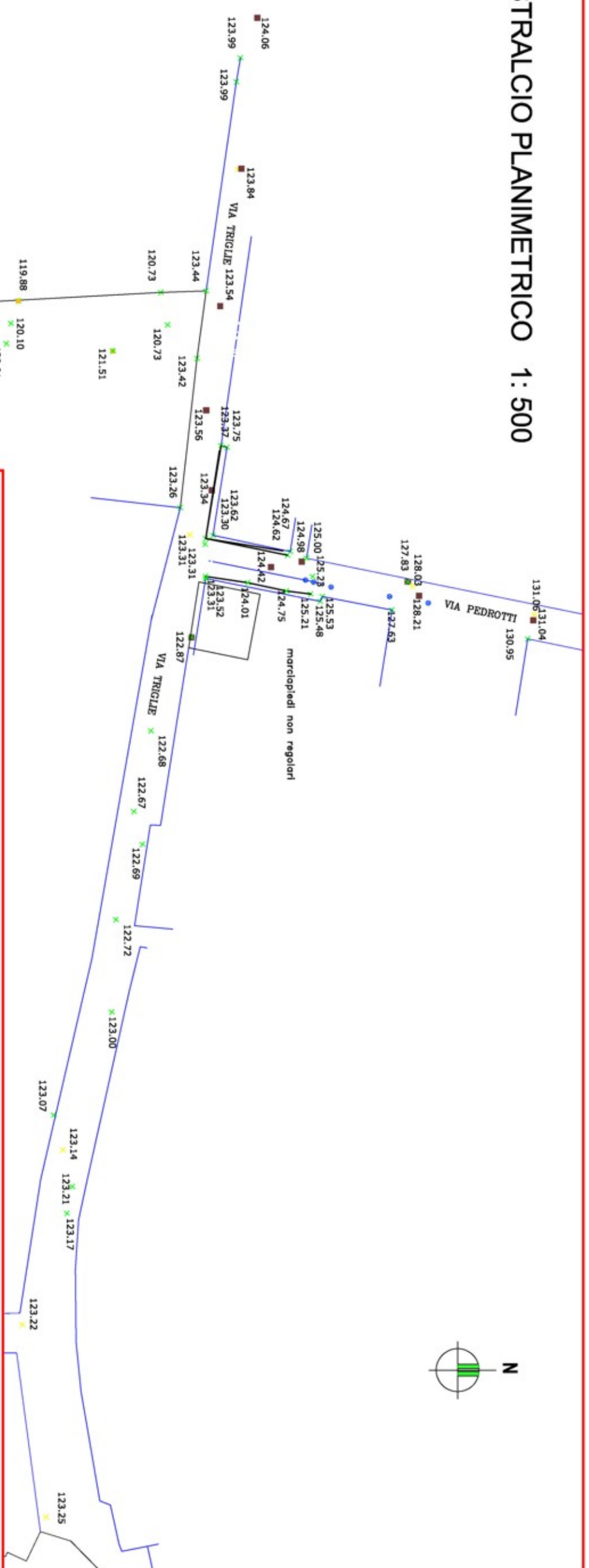
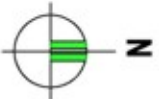

PLANIMETRIA 1: 5000

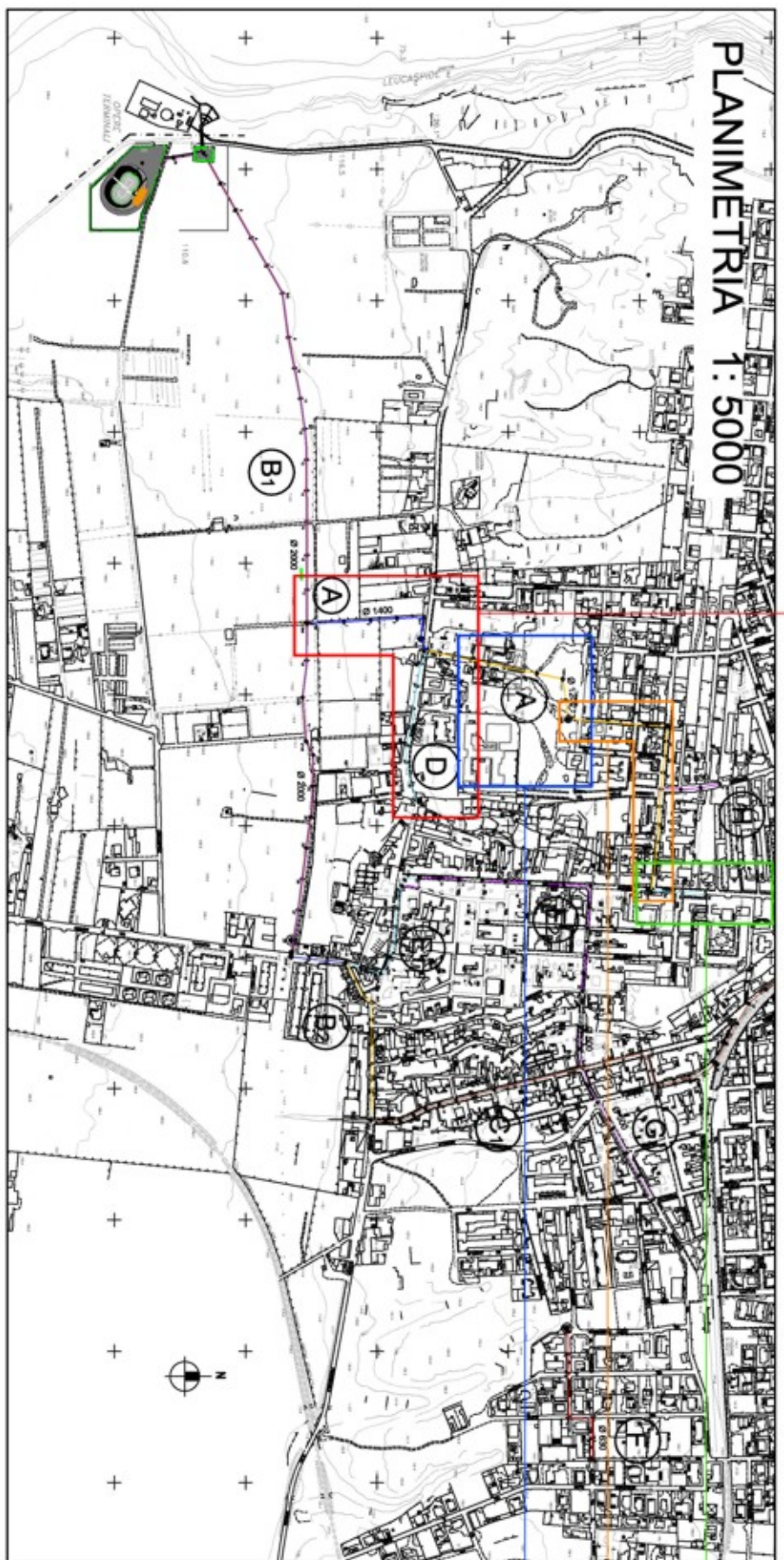

STRALCIO PLANIMETRICO 1: 500

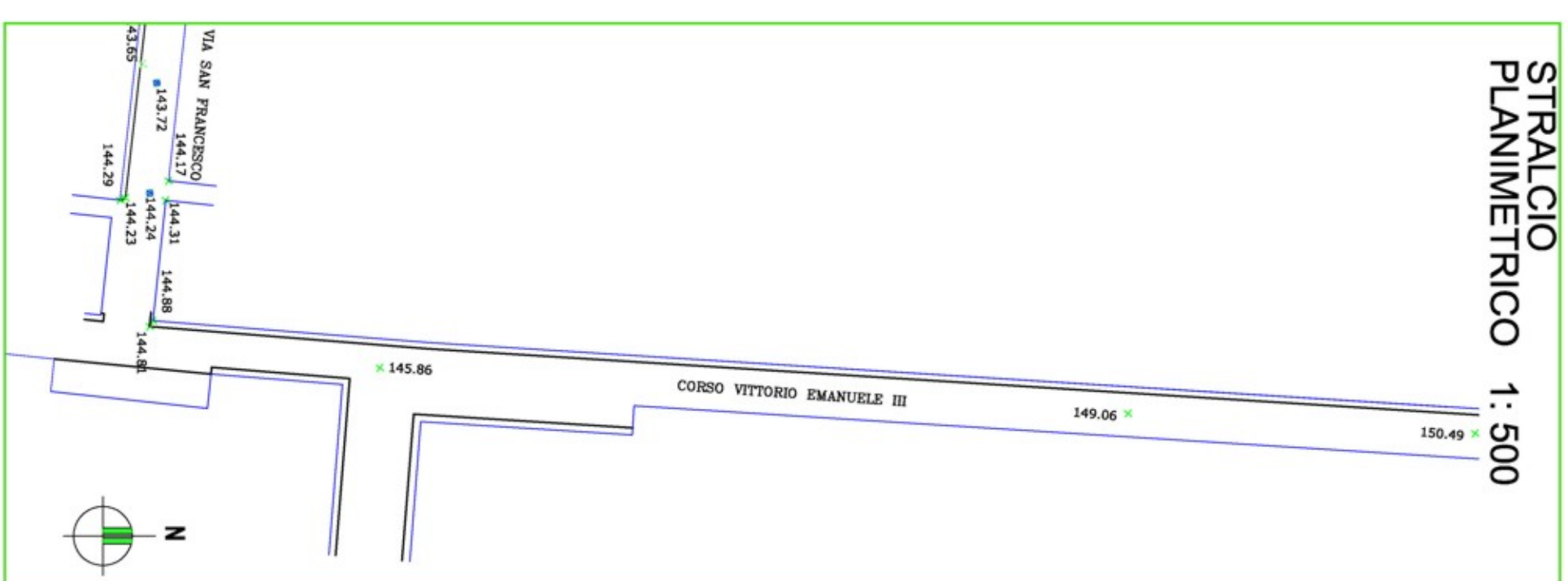

STRALCIO PLANIMETRICO 1: 500

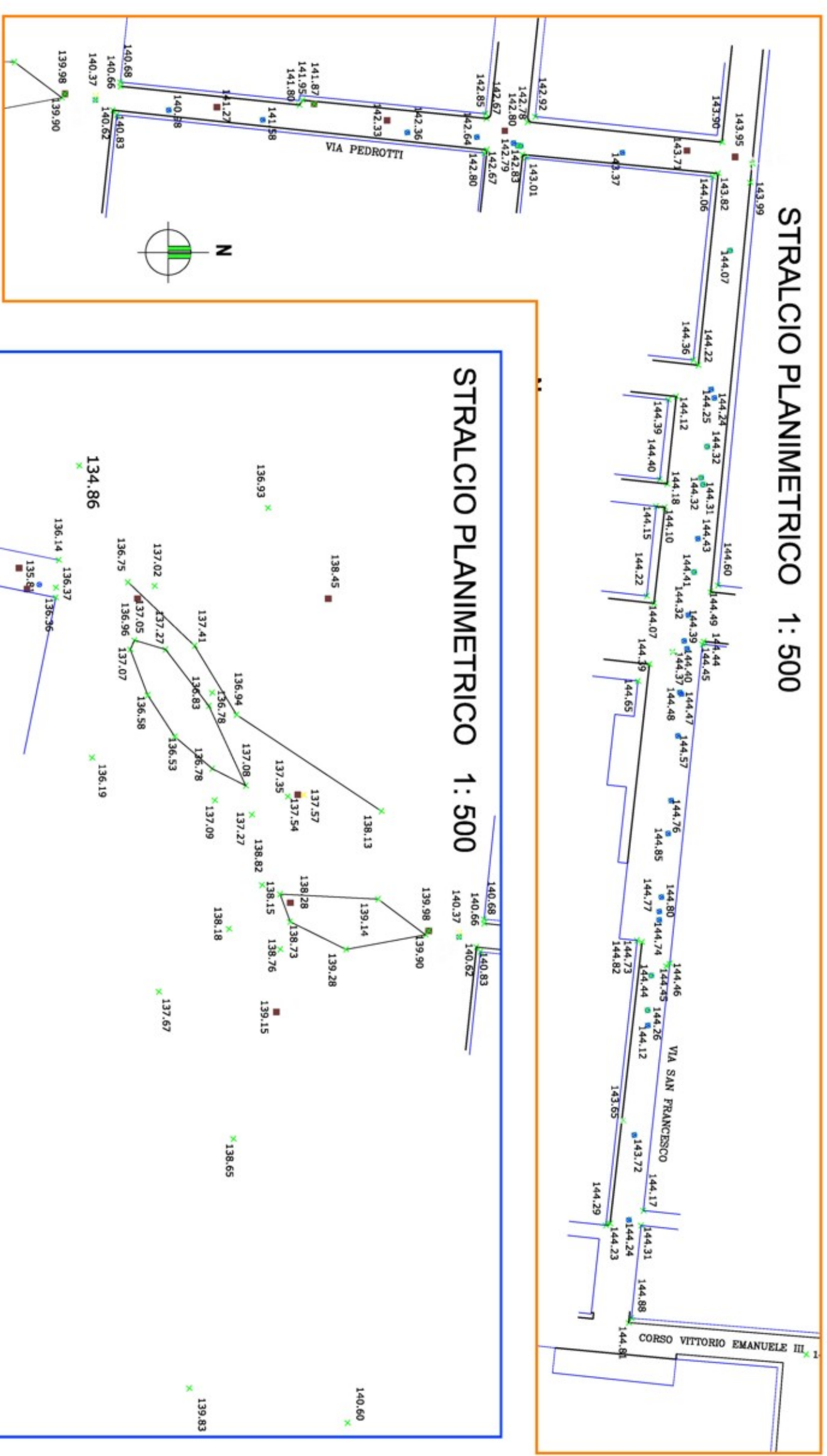

STRALCIO PLANIMETRICO 1: 500

